

58BW Open-In Window System

Built to the highest UK standards, the 58BW Window System delivers a high performance and cost-effective solution with impressively narrow profiles. Equally at home on residential and commercial projects, the system is available in a number of formats including Side Hung and Tilt-Before-Turn.

The system's clean lines and advanced functionality meet the demands of almost every modern building construction. Its competitive pricing also makes it a highly popular choice with specifiers both in the UK and around the globe. The system is certified under Secured By Design and tested to PAS 24.

DESIGN FEATURES

- › Certified under the Secured By Design scheme
- › Tested to PAS 24
- › Integrated deep head profiles for ease of trickle ventilation
- › Unique polyamide thermal break design to improve thermal performance
- › Tilt-Before-Turn system sightlines to match the casement window sightlines

OPTIONS

- › Available in two frame depths: 58mm or 70mm
- › Supports both open-in and open-out projects
- › Glazing 24mm-40mm
- › Available in the following configurations: Side Hung, Bottom Hung, Fixed Light, Multi-light and Tilt-Before-Turn
- › Available for Lifetime Homes (LFT)
- › Dedicated fixing straps for ease of installation
- › Designed with a Euro Groove to accommodate standard locking hardware
- › Available in single or dual colour polyester powder coating, texture and anodised finishes



SPECIFICATIONS

PERFORMANCE AND ACCREDITATIONS

| | |
|--|--------------------------|
| U-Value (Double Glazing) (Ug: 1.0 W/m ² K) | 1.5 W/m ² K |
| U-Value (Triple Glazing) (Ug: 0.7 W/m ² K) | 1.3 W/m ² K |
| Window Energy Rating (WER) | B - C |
| Air Tightness | Class 4 (600 Pa) |
| Water Tightness | Class 8a (450 Pa) |
| Wind Resistance | Class E2400 (2400 Pa) |
| Acoustic Performance | Rw (C;Ctr) 44 (-1;-4) dB |
| Security | PAS 24 & SBD |
| 3rd Party Certification Q-Mark | ✓ |

SYSTEM

| | |
|-------|-------------|
| Depth | 58mm & 70mm |
|-------|-------------|

CONFIGURATIONS

| | |
|-----------------|---------|
| Opening | Open-In |
| Top Hung | x |
| Side Hung | ✓ |
| Bottom Hung | ✓ |
| Tilt & Turn | ✓ |
| Fixed Light | ✓ |
| Multi-Light | ✓ |
| French Casement | x |

SIZE AND WEIGHT LIMITS

| | |
|----------------|---------------------------|
| Side Hung | |
| Max Size (mm) | 1725w x 2300h |
| Min. Size (mm) | 380w x 575h / 480w x 375h |
| Max Weight | 150kg |
| Bottom Hung | |
| Max Size (mm) | 1725w x 2300h |
| Min. Size (mm) | 380w x 575h / 480w x 375h |
| Max Weight | 150kg |
| Tilt & Turn | |
| Max Size (mm) | 1725w x 2300h |
| Min. Size (mm) | 380w x 575h / 480w x 375h |
| Max Weight | 150kg |
| Fixed Light | |
| Max Weight | 250kg |

GLAZING

| | |
|-------------------|---------------|
| Glazing Options | Internal Bead |
| Glazing Thickness | 24mm-40mm |

SYSTEM FEATURES

| | |
|-----------------------------|-------|
| Single Colour | ✓ |
| Dual Colour | ✓ |
| Textured Finish | ✓ |
| Anodised Finish | ✓ |
| Multi-Point Locking | ✓ |
| Lifetime Homes | ✓ |
| Sightline (Frame to Vent) | 86mm |
| Sightline (Vent to Mullion) | 100mm |
| Sightline (Fixed Light) | 43mm |

CAD CROSS SECTIONS AND THERMAL PROFILE

Additional details are available on request.

58BW Open-In Jamb detail

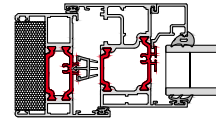

58BW Open-In Mullion detail

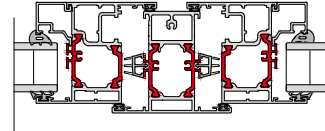

58BW Open-In Transom detail

